

# METFII (Temperature fixed type)

# METFIIA (Temperature fixed type with small range adjustment function)

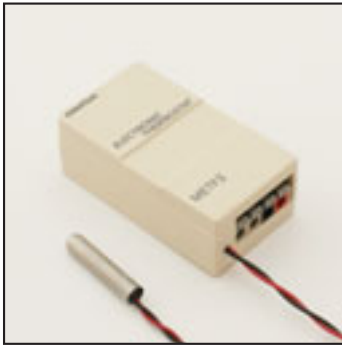

### Development Concept

1. Temperature fixed type electronic thermostat.
2. The smallest size among electronic thermostats.
3. A temperature setting tolerance:  
-30 to 0°C ; ±1.5°C  
0 to 140°C ; ±1.0°C.
4. Contacts capacity: 10 amp
5. One touch lead wire connecting.
6. With a mounting plate.



### Development Concept

1. This model is made by adding a temperature adjustable function to the METFII..
2. The preset temperature can be delicately changed (variable by ±4°C in the vicinity of the normal temperature).
3. Others are exactly identical to METFII.

### Ratings

- Power-supply voltage : AC115V, DC24V, DC12V selectable
- Contact current capacity : 50mA ~ 10A
- Voltage tolerance : 85% ~ 110%
- Power consumption : Approx. 2VA
- Sensor : Semiconductor sensor with 1m lead wire
- Output : 10Amp.1a relay
- Setting temperature : One point fixed temperature

### Characteristics

- Setting accuracy : ±1°C or ±1.5°C
- Differential : 2k ~ 10k
- Contact designation : ON/OFF changeover at a setting Temperature
- Insulation resistance : 100MΩ(DC500V megger)
- Voltage tolerance : AC2,000V/2 sec.
- Vibration tolerance : Selected from JIS·C·0911-1984  
Constant vibration : 50Hz fixed/0.2mm fixed(1G)  
Sweep vibration : 10-55Hz/0.35mm fixed(0.2-2G)  
Withstands for 2 hour each in directions X, Y and Z
- Impact tolerance : No damage when dropped three times from the height of 40cm onto a concrete floor (approx. 70G).  
Withstands substantial impact when packed or mounted in equipment.
- Life : 1 million mechanical operations or more.  
100,000 electrical operations or more.
- Weight : Approx. 40g(0.1lb)

### Dimensions

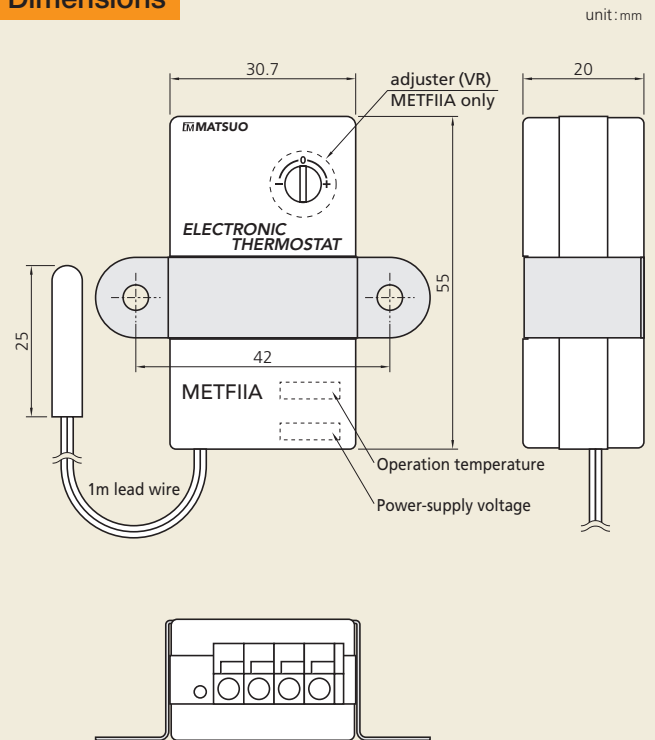

### Please specify the following points

1. One of power source among AC100V, DC24V and DC12V
2. Setting temperature between -30°C and 140°C
3. Differential between 2°C and 10°C
4. X or Y  
X : Open at a specified temperature when a temperature rises  
Y : Close at a specified temperature when a temperature falls
5. Model indication

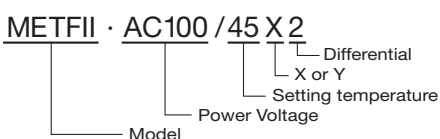

### Schematic

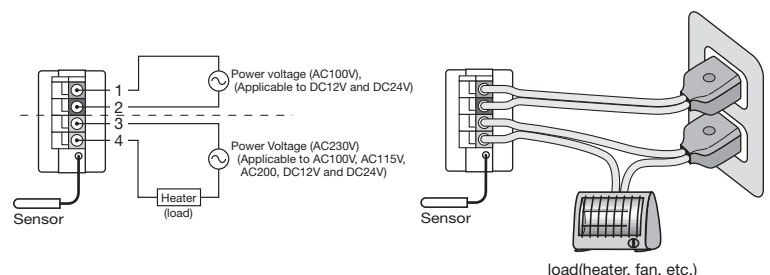

Note: The catalogue is subject of change without notice. Please contact us to confirm the specifications of quantity purchase.